



St Alphege, Seasalter

St Alphege, Seasalter **Parish Profile**





Team Vicar of St Alphege, Seasalter



St Alphege Seasalter, situated within the North Kent coastal town of Whitstable, is a lively church which has grown substantially over the last 10 years. We believe in every member ministry and collaborative leadership and follow our calling to make disciples of Christ and grow the church of God. We are seeking a Spirit-filled person who will help us build on the foundations already laid and guide us on the next stage of our journey.

We hope that the following pages give you a sense of the vibrant community of faith at Seasalter. Please read our profile and then consider whether, after prayer and discernment, you could be the person God is calling to join us.

Contents

| | |
|--------------------------------|-------|
| Our Vision | 3 |
| Our Church | 4 |
| Who We Are Seeking | 5 |
| What We Can Offer You | 6 |
| Our Town | 7 |
| What Sort of Church Are We? | 8 |
| What Are We Like? | 9 |
| Leadership | 10 |
| Staff Team | 11 |
| Worship | 12 |
| Prayer | 13 |
| Children's & Families Ministry | 14 |
| Seasalter Youth | 15 |
| Twenties | 16 |
| The Third Age | 16 |
| Healing & Wholeness | 17 |
| Small Groups | 17 |
| Mission & Partnership | 18-19 |
| Buildings | 20-21 |
| Finances | 22 |
| Communications | 22 |
| The Whitstable Team Ministry | 23 |
| The Clergy Team | 24 |
| Reculver Deanery | 24 |
| Canterbury Diocese | 25 |





Our Vision

Belonging. Believing. Becoming. Transforming.

Our vision comes from what we see God doing...

We can see our lives, our town and our world being transformed by the power of God's love in Jesus Christ.

Our vision also comes from our calling...

We are called to encourage belonging, and nurture believing, so that we may all become followers of Jesus who share God's love for the world.

Our Purpose...

We are called to make Disciples of Christ and grow the church of God.

Our Values...

All involved *Everyone playing their part*

Bearing witness *Telling the Christian story*

Creating Community *Loving and belonging*

Deepening discipleship *Following Jesus, becoming like him*

Encountering God *Experiencing His presence*

Finding friendship: Fun and Food *Laughing and sharing*

Giving generously *Giving with gladness*



Our Church

We are a welcoming church, steeped in prayer and experienced in change. We welcome and encourage all members of the church family to be involved and participate in active ministry.

25 years ago St Alphege Seasalter comprised some 50 people gathering in the tiny mediaeval Old Church. Today our average Sunday morning attendance is between 220 –270 (adults & children) in the modern Seasalter Christian Centre with a similar number of fringe members. This extraordinary story of growth has not all been plain sailing but through it all we have seen God's hand guiding and holding us. Today we see some of those who were toddlers 25 years ago taking leading roles in worship and other parts of the church's life.

We have thriving ministries with children and families, young people, "Twenties" and those in their Third Age, as well as everyone in between. There is also a well-established Healing Ministry.



Our purpose is to make disciples of Jesus Christ and play our part in growing the church of God. We are an "intentional" church, seeking to use our skills and resources to further that purpose.

We are one of the five churches in the Anglican Whitstable Team Ministry. Since the Team was set up in the 1980s relationships have developed, while giving space to the individual churches to pursue their own mission imperatives.

Located just 7 miles from the centre of the Anglican Communion in Canterbury we are conscious of our roots. We commemorated the millennium of the martyrdom of our patron saint, Alphege, in 2012. Being the only church in the Seasalter district of Whitstable we include in our number many who didn't expect to find themselves as Anglicans!

Who We Are Seeking

A Spirit-filled person with a passion for the Lord and God's work with experience of growth in either a church or secular environment, who is able to build on the solid foundations already laid. You will have the ability to be flexible whilst maintaining strong leadership values with a clear focus on God's direction.

Leadership

You are a proven leader with courage, grace and humility who is able to grow and lead leaders, inspiring and enabling others to fulfil their gifts and God's calling within the church, providing clear guidance, direction, support and encouragement.

You are a good communicator and networker with a desire to work with other churches to spread God's word and grow his Kingdom. You will want to work with key individuals in the area to support communities and social cohesion.

You will be creative in your outlook, aware and sensitive of the different needs and traditions within St Alphege Seasalter and an enabler for people to feel secure who are unfamiliar with church.

Your leadership style could be described as servant-hearted.

Teaching

With a deep understanding of God's word you have the ability, energy and enthusiasm to preach the Gospel in a variety of styles. Your teaching, rooted in the Bible and made relevant for today, has a balance of challenge and encouragement and is able to reach all ages.

You are prayerful and spirit-led, able to develop the gifts of the spirit within the church family and encourage and support existing Christians to grow in faith and lead others to come to Christ.

A key part of your work is supporting and developing others to take the lead in ministry, preaching, worshipping, praying and leading services.



Friendly, Compassionate & Understanding

You will have the ability to really engage with and encourage all ages through pastoral care that demonstrates accountability, understanding and compassion.

You are someone who always strives to see others as Jesus sees them - with love, compassion and understanding.

You have energy and drive to relate well with people of all ages and from all backgrounds - to listen to them and understand the world from their perspective whilst also radiating God's love for them.

You are fully supportive of safeguarding in all aspects of church and community life.



And finally we are a church family who have found that a sense of humour in all of us is essential!

What We Can Offer You

We are a friendly, caring church family where you will receive a warm welcome. We want to support our vicar as we work as a team to fulfil our part in God's mission and ministry here in Whitstable.

Team Vicar of St Alphege is a significant role but there will be many exciting opportunities for us to explore as we journey together. We are also keen to ensure that your day off is respected and that you have sufficient time and space for study, reflection and prayer as well as down time to relax and recharge!

While you will develop our strategic vision with the Ministry Leadership Team, members of the Staff team will enable you to delegate significant areas of responsibility. The District Church Council works well together and is practised at taking a strategic view, and all the major roles in the church are filled.

We currently have four retired priests in active ministry and many lay members who take on various roles within the church.

Whitstable is a delightful, popular coastal town which has much to offer. There are numerous activities taking place particularly during the summer months.

Canterbury is only 7 miles away and we are well placed to reach both London and the Continent within 90 minutes.

Whitstable provides good education for children with seven infant and junior schools and one senior academy school. We operate under the Kent Test system and grammar schools are located in Canterbury and Faversham, a bus or train ride away.



Our Town

Whitstable is a seaside town on the north Kent coast, 7 miles from Canterbury and 5 miles from Herne Bay. It has a predominantly white population (98%) and has an overall population of about 32,000.

Life is centred very much on the working harbour whose activities include: fishing, fish processing, cargo handling and boat storage. The harbour area is also the home of other businesses such as tarmac manufacture and maintenance of an offshore wind farm.



It has also become a very popular focus for tourists and there is now an area called Harbour Village, based within the harbour which offers food and artisan gifts for tourists. Tourism is now a very large part of Whitstable's culture and plays a vital part in the town's revenue.

Whitstable is also famous for its oysters which have been gathered from these shores since Roman times.



The landing of the oysters is still celebrated each year when they are blessed by clergy at the annual Oyster Festival. At low tide you are able to see the oyster beds lying in the mud near the shore. They are a staple on the menus of many local restaurants including The Sportsman, a Michelin starred restaurant which sits on the Seasalter Marshes.

St Alphege church is situated in Seasalter - there is another St Alphege church situated in the centre of town - which is a residential area of Whitstable with a population of around 8,000. It is located at the west end of the town where there are several caravan and mobile home parks.

Water sports are extremely popular throughout the year and there are three sailing clubs based in Whitstable, Tankerton and Seasalter. The beach and promenade is used by many dog-walkers, cyclists and families.





What Sort Of Church Are We?

Thoughts from our church family meeting...

Our nature is to be

*Collaborative | Diverse | Supportive | Discerning
Gifted | Active | Growing | All-age | Fun*

With God we are

*Prayerful | Spirit-filled
Worshipping | Bible-based*

We try to embrace

Change | Creativity | New Things

To others we try to be

*Open | Welcoming
Caring | Friendly*

To the world we are

Generous | Outward Looking

We love to have:

Good teaching | Active Cell groups

Looking forward we are

Visionary | Committed | Focused



What Are We Like?



We are a social church family who like to pray, eat and share time together. We have a passion for outreach and that is reflected in our activities and in our willingness to publicly demonstrate our faith through baptisms in the sea, which often gather a crowd.

We recognise we are on a journey, have come far and still have far to go in serving God and spreading his word. We encourage all to be involved, whether it is in serving coffee, stacking chairs, prayer ministry or teaching, we believe all can contribute, use and develop their God-given gifts.



Ashburnham

Every two years we spend a weekend at Ashburnham Place in Sussex, a place of rest, retreat and refreshment. On average we take 170 people from the church family. We go for spiritual nourishment, plus fellowship, food and fun. We always have a guest speaker.

The building is set in around 220 acres, so we are treated to some beautiful natural surroundings guaranteeing peace and quiet.





Leadership

Churchwardens



Lynda Kemp has faithfully served as a churchwarden for six years.



Alison Fuller stepped up from deputy-churchwarden in December 2017.

PCC | Parochial Church Council

St Alphege, Seasalter is part of the Whitstable Team of Anglican churches and the PCC is the legal body which holds the Team together. It meets quarterly and discusses overall strategy and co-ordination between the churches. However all the churches day-to-day management and responsibility for such issues as finance and buildings is in the hands of the...

DCC | District Church Council

The DCC is made up of 19 members, 16 of whom have been elected either directly by church members or through their membership of other bodies such as the Deanery Synod.

The DCC meets every two months and always starts the meetings with prayer and worship. We are a praying church – and not just on Sundays! Any decision made and agreed by the DCC has been carefully discussed and thoroughly prayed about. Doing some of the detailed work for the DCC are the Finance and Standing Committee, the Safeguarding Group and the Closer to Home Group. Working alongside the DCC is the ...

MLT | Ministry Leadership Team

The MLT meets every month to pray and reflect on the things that are happening in our church at Seasalter. They eat together, share together and pray together. All 3 are pretty crucial! The MLT tries to discern what God might be saying to St Alphege Seasalter and what that might mean for how we 'do' church together. It's not there to make formal decisions – that's what the DCC does – but it is there to help the DCC by focusing prayerfully on issues we think we should be grappling with together, always asking God to show us what He has for us next, and how He wants us to get there. Working with the DCC and the MLT there is the ...



Staff Team

A collection of talented individuals who head up the various areas of work and ministry.



Jane Myhill is our full-time employed Children and Families Minister overseeing all our activities with children up to 11 years old and their families.



Dan Ralph is our part-time Youth Leader. He is one of the administrators at the Christian Centre. Also, as our Digital Co-ordinator, he oversees the website & social media.



Georgina Hedley-Smith is our other part-time employed Youth Leader. She has been developing our work with teenagers and young adults over the past 4 years.

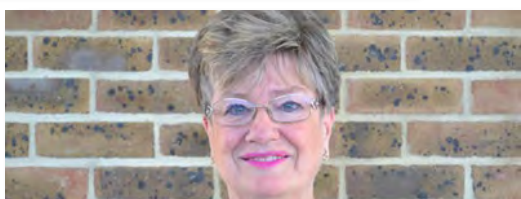

Denise Critchell is our Pastor for Healing and Wholeness, heading up our team who prays with and for individuals and situations.



Tobi Osinaike is our Prayer Pastor. He joined us over 2 years ago and has led a transformation in the prayer life of the church.



Chris Skingley leads our ministry with those at the higher end of the age spectrum as the Pastor for the Third Age.



Becky Whittaker works alongside Dan, overseeing the administration of Seasalter Christian Centre.



Worship

Services every Sunday at Seasalter Christian Centre

Our services are led and preaching undertaken by both clergy and laity and we have a variety of worship bands who lead sung worship at all of our weekly Sunday services.

8.45am Holy Communion

Peaceful worship and teaching for about an hour using the Common Worship Holy Communion service.

10.10am Lighthouse

A 30-minute service for everybody with an emphasis on families and children.



11.00am All-age Worship

Everybody welcome to a service with more time for worship & learning from the Bible. In term time there are groups for children & youth during the service.

6.30pm Y

A service led by our young people for our young people.

At the Old Church

11.15am Book of Common Prayer Holy Communion (first Sunday of the month)

Traditional worship in a place of prayer and peace

During the week, every week

9.15am Tuesday & Friday Morning Prayer

9.15am Wednesday Holy Communion

These services last about 45 minutes, are simple, informal and include Bible study and prayer.

As we say on our website...

We offer a relaxed welcome and we avoid too much formality in our worship. There's good coffee and tea, a bit of a fight for the biscuits and there's no charge for the pleasure.

- There's no dress code - you can be yourself in God's presence.
- Sit where you like, including at the back if you just need to see what goes on.
- We'll come and say hello but there's no pressure on you to be anything but yourself.
- We don't use books at the Christian Centre, any words are projected onto the screens.
- If you are just visiting, you are not obliged to contribute to any offering or collection.



Prayer

Our desire is for prayer to be the heartbeat of St Alphege Seasalter. Jesus instructs us 'to pray and not give up' (Luke 18:1). We long to be a church where people of all ages feel comfortable communicating with God and have a hunger to seek Him with perseverance.

Our aim is to cultivate a culture of prayer that has thanksgiving at its core and to be a grateful people who are pursuing God for the greater things. We believe that prayer is the key that unlocks the blessings of heaven: we need only ask. We are building a community that prays all the time and uses prayer to change the world.

We gather to pray every Sunday from 7-8am before church and every Wednesday from 6-7am. - this is known as The Shift. Every Tuesday and Friday there is Morning Prayer at the Old Church at 9.15am. We also have regular prayer meetings on a Friday evening. PrayerPoint is 6-7pm and Silent Prayer of the Heart is 8-8.30pm.

From time to time we hold prayer events such as 24 Hours of Prayer and a Half Night of Prayer. We also have

prayer ministry available during and after each service on a Sunday, for those who would like someone to pray for them.

We have a Facebook page entitled 'St Alphege Seasalter Prayer Requests' to which 176 members of our church family subscribe. It has proved to be invaluable over the years, enabling us to give or receive immediate support 24 hours a day.

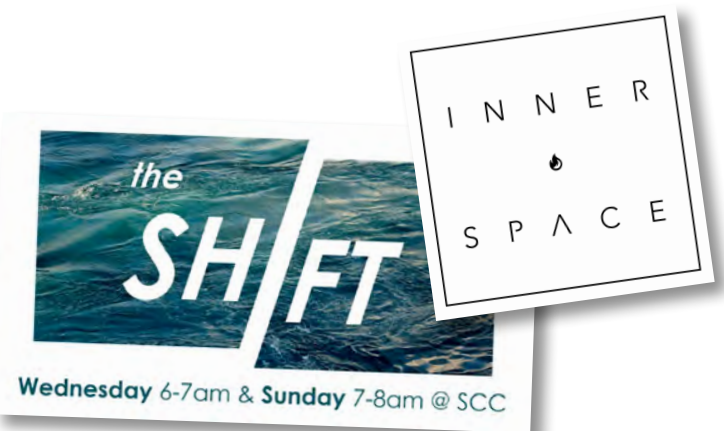

Our Vacancy Prayer

God our Father, you call us to be the body of Christ here.
Send your Holy Spirit at this time of change;
Fill us with vision, energy and faithfulness in prayer.

May this vacancy be a time of deeper love and fellowship,
as you guide us with your heavenly wisdom.

Help us to choose the one who will share with us in your
perfect plans, in the name of Jesus Christ our Lord.

Amen

Children & Families Ministry

God loves everyone from the youngest to the oldest. Here at St Alphege Seasalter we want to take special care of our youngest! We have a dedicated and innovative Children and Families Minister, Jane, who is passionate about sharing the good news and encouraging children to learn and grow in faith.

This ministry has a committed team of volunteers who serve at regular clubs and organised events which include Kickstart (the school holidays club) and our weekly groups Jelly Beanz (for bumps and babes), Pulse (the after school club) and Alphies (for babies and toddlers). These groups provide opportunities for friendship and for Christian teaching. A pastoral emphasis is on all the work done by Jane and the team.



Seasalter Youth

A Christ-centred generation of young people, daring to make God number one.

Our desire is for every young person to feel they belong when they come to St Alphege. We value our young people and want to nurture and grow them to live in the Spirit of God.

Our Sunday evening service 'Y' is organised and led by our youth, for our youth. It is a place where gifts are discovered and utilised. The youth are involved with preaching, service leading, technical team and prayer. They have their own Cell groups. Y has its own leadership team (YLT) to focus only on this service.

There are two part-time dedicated youth workers, Georgina and Dan, who work to support and grow our youth in faith and number. Groups attend Soul Survivor and Carrotty Wood each year. We long for our young people to be trailblazers of faith in Jesus and to be boldly following God wherever He is calling them.





Twenties

Our '20's' or 'Young Adults' as they are often called, are a group where we are seeking growth and engagement. This group is very active within our church: leading and participating in a Cell, preaching, service leading, serving coffee, and outreach work with other groups in church and further afield.

Last year, a group attended Naturally Supernatural for the first time. They are a welcoming group who want to learn more about the Lord, grow in their faith and gifts of the Spirit. Through a changing decade of life, they provide each other with vital support, encouragement and friendship.



Third Age

Although 'Third Age' is generally understood as the period of life in active retirement, it is used here in a more flexible way to refer to all the older people we connect with. Our desire is to champion individuals who are at this stage of life.

We are committed to supporting these individuals in sharing the invaluable gifts, wisdom, and ministry that blesses the church so richly. We aim to resource the spiritual journey of the older generation by offering pastoral care as well as quiet days and opportunities to nurture faith in a loving environment. There is also a generous helping of tea and cake, singing, crafts and quiz afternoons!



Healing & Wholeness

Healing and wholeness is an ongoing process. We want to enable God to work out His desire for our lives, so that we can begin to experience the abundant life that Jesus promises. We aim to grow in our love for God and for one another.

We desire to let our barriers down so that we can be open to embrace all the amazing benefits that Jesus won for us on the cross. Our aim is to partner with people in prayer and in love, so we can allow the Holy Spirit to bring healing in our lives.



Small Groups

We call our weekly small groups Cells.

We love them because:

- Cells are safe places to grow in faith
- Cells help build up the whole church
- Believing is about belonging

There is a lot of laughter and food at Cell!

There are cell meetings every day (except Tuesdays which we keep free for other church meetings), some in the afternoons and some in the evenings. Cells are open to everyone, and everyone is encouraged to belong to one.

There are 15 cells with a membership of over 100 but we long for more to be involved.

Cell leaders meet regularly for support and there is a team of Cell Supervisors whose role is to share oversight of the Cells at Seasalter.





Mission & Partnership

CLOSER TO HOME

The Closer to Home Fund was born out of the church's commitment to tithe an amount (£90,000) equal to 10% of the building cost of the Christian Centre in 2007. Since then we have added to the Closer to Home Fund an amount equal to 10% of the Freewill Giving to the church each year.

Through our Closer to Home ministry we offer support to ministries locally, nationally and globally. As a church we continually experience God's generosity through his people, so we want to be part of God's transforming work close to home and far away. We do this through partnering with individuals, churches or agencies serving God's kingdom elsewhere.



In 2017 we gave direct financial support to the following ministries:

Local Ministries

Foodbank • Canterbury Schools Work • Porchlight • The Haven Project
Catching Lives • Beach Pastors • Together Canterbury
Christians Against Poverty • Joy Lane School • The Living Well

National Ministries

Church Army • Church Pastoral Aid Society • Church Urban Fund • Youth with a Mission

International Ministries

Grass Roots (Romania) • LIV Village • Education for the Children
Mission Aviation Fellowship

Mission & Partnership

Community Ministries

Lucerne Drive - 'Doing Life Together'

As our main focus we seek to reach out actively to our neighbourhood estate. At the heart of the vision is a desire to see the life of God expressed in ways that are relevant and authentic to the Lucerne Estate community. We are currently discerning what the next steps will be and it is hoped that in time, some form of Christian community will be expressed.



Beach Pastors

Ascension Trust's well known Street Pastor scheme with a Whitstable twist! St Alphege Seasalter is heavily committed to this project and many church members are either on the Prayer Team or take the role of a Pastor.



The Haven Project

The Haven Project is an exciting initiative by Churches Together in Whitstable. Volunteers from St Alphege Seasalter and all the churches provide light refreshments and laundry and shower facilities to rough sleepers each Wednesday afternoon at St John's Methodist Church.

Foodbank

A Christian-led community project providing emergency food parcels to individuals and families in short term financial crisis. Several of our church family help with delivering, sorting and distributing across the Canterbury district. The Christian Centre has a bin from which weekly collections are made.



Christian Against Poverty

CAP runs a network of CAP Debt Centres throughout the UK in partnership with local churches. We have Befrienders and people from Seasalter on the Prayer Team who support Whitstable's mini-centre.



Canterbury Christian Schools Work Trust

Ministry to, and support for, primary and secondary schools in Canterbury, Whitstable, Faversham and Herne Bay. The Primary School worker is from our church family, and many folk have supported this ministry for a long time.



Buildings

THE OLD CHURCH

Known locally as simply 'the Old Church', this delightful place of stillness and prayer has a special place in the heart of our busy church community. It dates from 1140 and is soaked in the prayer of God's people. Encountering God is one of the seven core values of the church, symbolised by the presence of the Old Church as a place which is set aside for prayer and worship.

The Old Church is used during the week for worship, Bible study, intercessory and silent prayer. There is a monthly BCP Holy Communion service with a small but regular congregation. It is also used for baptisms, weddings and funerals.

We have a vision to reorder and restore the interior of the church so that it becomes a more welcoming space, and to develop the church as a place of retreat, both for members of our own congregation and for individuals and groups from further afield.



We are pleased to be able to say that the Faculty has now been granted, and although we have not yet raised all the money needed - we have 70% - we plan to devise a phased approach to the work which we hope will start in Summer 2018.

THE VICARAGE

A modern 4-bedroom family vicarage within a few minutes' walk of both the Christian Centre and the Old Church. There is a good sized study at the front of the house, separate from the family living area. It has a single garage and a medium sized garden laid to grass.



Buildings

SEASALTER CHRISTIAN CENTRE

When the Christian Centre was built 10 years ago the vision was for “a community building in which the church meets” rather than the other way round. And so it has proved.

Used extensively throughout the week for events large and small involving church groups and meetings, local community activities and public sector commercial hirings (not to mention acting as a polling station), it has proved to be one of the hubs of the community.

A unique feature is the entrance concourse, which naturally flows into the 250-seat auditorium, as well as three smaller meeting rooms all of which are well equipped for a variety of uses.

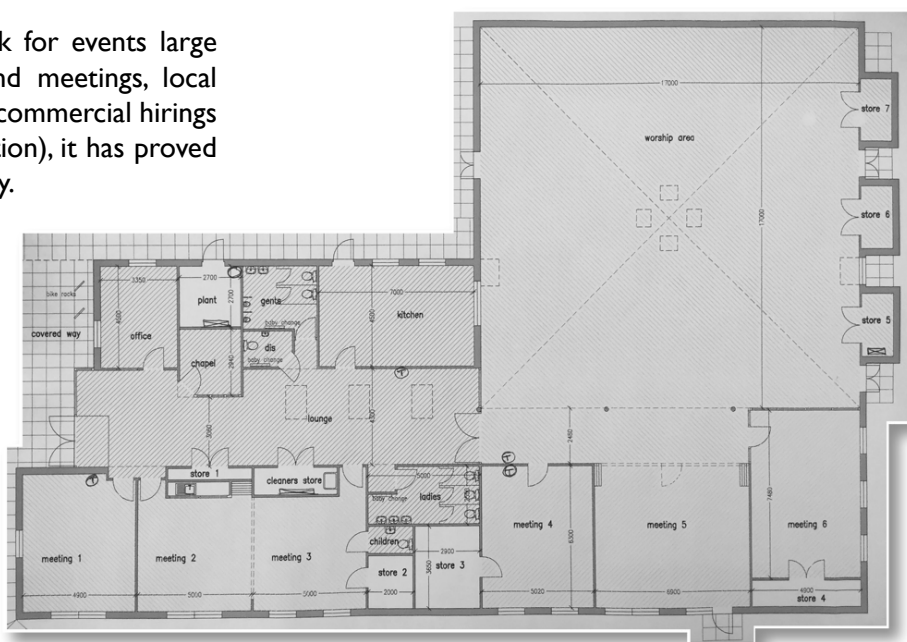

ABBOT HOUSE PRE-SCHOOL NURSERY

Adjacent to the Christian Centre is a bungalow housing the church’s pre-school nursery, Abbot House. It has an “Outstanding” rating from Ofsted. Owned by the church (with the help of a mortgage) it has been adapted for its present use and features an all-weather garden.



Finance

Giving generously is one of our core values. We are grateful for God's wonderful generosity in Christ, and for the many ways God has provided for our church family.

As a community we practice the grace of generosity, seeking to serve Christian mission close to home and far away. We commend the tithe as the standard for Christian giving in good times and in bad, and we seek to rely on the resources of God for the work of God.

We have a Planned Giving Scheme with annual Stewardship renewal programmes. The total income of the church in 2017 was £214,375 and our normal pattern is a small annual surplus or deficit. We always pay our Parish Share in full and on time (2017 = £103,000) and give away to partners local, national and international an amount equal to one tenth of the voluntary giving to the church (the Closer to Home initiative).

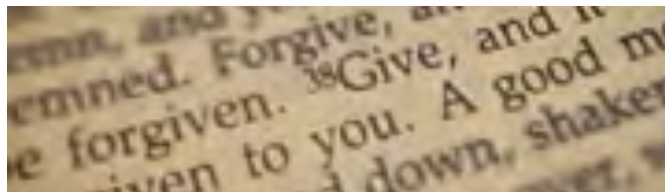

Over recent years we have discovered the effectiveness of appeals for specific projects in releasing the generosity of the church family. For the building of the Christian Centre the church family provided £600,000; the Youth Ministry is funded through a restricted fund which has received over £60,000 in the last three years; an appeal for £9,000 to assist a theological college in the Congo raised £13,000 and the project for the restoration and renewal of the Old Church raised £60,000 last year.

A copy of the 2017 accounts is available at: https://www.stalphegeseasalter.org/Groups/296391/Annual_Accounts.aspx

Communication

Our website was updated in 2016 and has lots of information about the church and what is happening. Our [Sunday sermons](#) are uploaded weekly, and people can subscribe to the St Alphege Seasalter Podcast on iTunes to have sermons delivered directly to their phone.

We are on social media, with a longstanding presence on Facebook which is growing. We have a Twitter account, plus a recent addition of Instagram too.

Every week notice sheets are handed out to the church family at all services keeping everyone informed of what is happening. It also sent via email to those who prefer an electronic copy, as well as being available on the church website.

We also share the Unity Update, which is the name of our monthly news sheet which covers all the churches in the Whitstable Team.

Please click on the images to see more.

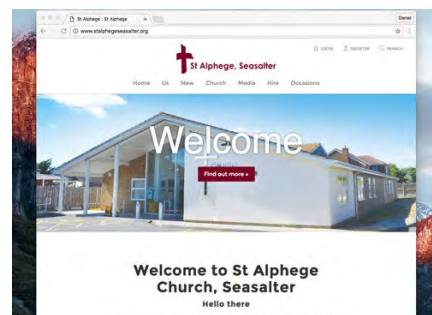

The Whitstable Team Ministry

The Whitstable Team Ministry exists to enable the churches through collaboration in mission to reflect God's love in Whitstable.

The Whitstable Team Ministry was formed in 1984 and comprised the six Anglican churches in the town—All Saints, St Alphege Whitstable, St Alphege Seasalter, St Andrew's, St John's and St Peter's. (St Andrew's no longer has a congregation, but remains part of St Alphege Whitstable's outreach). There are also 2 Church of England Schools - St Alphege CE Infants School and Whitstable and Seasalter Endowed CoFE Junior School.

The Team operates like a group ministry in that each church has its own District Church Council and is responsible for its own financial affairs and for the maintenance of its building and property. Significant capital projects have to be taken to the PCC for its support.

The Whitstable Team is legally the Ecclesiastical Parish of Whitstable (Registered Charity 1134171) and the PCC thereof is the accounting body. Under Charity law the PCC has to produce consolidated accounts bringing together the accounts of the 5 constituent churches. In 2017 the total unrestricted income was £628,000 with an overall deficit of about £33,000.

The Diocese of Canterbury allocates Parish Share to deaneries and Reculver Deanery has its own formula for dividing this among the parishes. The Whitstable Team allocates its Share at a meeting of church representatives each November

The working together of the Team churches is shown in:

- Chaplaincy at the Whitstable & Tankerton hospital
- The Marriage Preparation Team
- The Team-wide Mother's Union fellowship
- The Boxing Day Lunch for people on their own at Christmas
- The Fellowship of Prayer—a regular themed booklet
- Ministering to the housebound and local Homes

Average Weekly Attendance (Adults)

| | 2015 | 2016 | 2017 |
|-----------------------|------|------|------|
| All Saints | 136 | 130 | 135 |
| St Alphege Seasalter | 219 | 207 | 199 |
| St Alphege Whitstable | 94 | 91 | 97 |
| St. John's | 42 | 53 | 53 |
| St. Peter's | 23 | 25 | 24 |

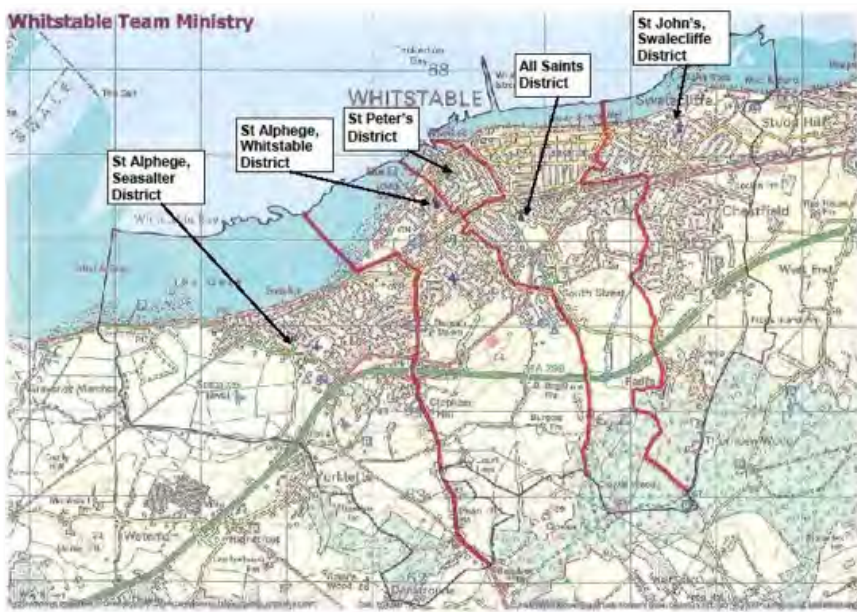

The Clergy Team

Values

As our commitment to enable us to achieve our purpose as a team we will:

- Communicate and receive each other's realities, hopes and plans
- Aim to support each other with honesty, openness, compassion, generosity and respect
- Explore and celebrate our mutual needs, differences and calling
- Work together to liberate and support the churches in mission

Practically, this means:

- Monday meetings (except on Deanery Chapter weeks) – Sharing, including group supervision, communion, business; (Two Clergy Team Away Days per year)
- Weekly Team evening prayer Mondays 5 – 5.30pm;
- Regular Team Sundays; Annual Parish Ascension Day communion service;
- Sharing pastoral offices across the parish including liaising over PMDs;
- Regular assemblies at Whitstable Endowed CE Junior School;
- Monthly Churches' Together in Whitstable ministers' lunch, other shared events and mission;

Reculver Deanery

Reculver Deanery covers the towns of Whitstable and Herne Bay and the associated villages.

Whitstable area is covered by a team ministry whose clergy have regular weekly meetings. The three incumbents of Herne Bay/Herne meet informally for mutual support about every six weeks. The deanery has been privileged to have up to three curacy posts.

The chapter meets nine times a year which includes a three day retreat in September.

The Deanery Meetings are open meetings with all welcome to attend, and look at various areas of ministry. Deanery Synod meetings, to cover the official Synod business, happen after the open meetings and are normally brief! Each church elects its own Synod representatives.

The deanery leadership is convinced that the deanery exists to support the work of the local churches in their mission and priorities.

Canterbury Diocese

Changed lives, Changing Lives

Canterbury Diocese, the oldest diocese in England, stretches from Maidstone to Thanet, the Isle of Sheppey to the Romney Marsh and includes 328 churches in 253 parishes, along with 103 church schools, organised in to 15 deaneries and three archdeaconries, Ashford, Maidstone and Canterbury.

Whilst the Archbishop of Canterbury is the diocesan bishop, day to day oversight of the diocese is delegated to the Bishop of Dover, the Right Reverend Trevor Willmott.

Objectives

Encompassed by the statement: living faith, building community, transforming lives, the Diocese of Canterbury is committed:

- *To grow the church numerically and spiritually.*
- *To re-imagine ministry.*
- *To build partnerships that enrich communities.*

In 2017, after over a year of prayerful conversation and discernment, our Synod further refined these priorities for the next season of our life together in mission.

We committed ourselves

- *To be a people renewed in missional prayer across our Diocese.*
- *To grow our Diocesan Ignite ministry, to reach the most marginalised in our communities with the good news of Jesus Christ.*
- *To specific evangelism and discipleship initiatives with teenagers.*
- *To develop a school of leadership to build on the extensive lay and ordained training opportunities which we currently offer.*
- *To develop an innovations hub which offers resources to equip local mission*



Frameworks

To facilitate the achievement of these objectives, the work of the diocese is focussed into four key 'frameworks':

- Children, schools and Young People
- Local Church Development
- Licensed Ministries
- Communities and Partnership

All these are supported by our Resource Management & Compliance Group.

These frameworks replace the traditional concept of Boards and Committees and represent a flexible way of working for the Diocese with communication and collaboration at its heart.

Mission Action Planning

The Diocese uses Mission Action Planning as a process and planning tool to help deaneries, benefices and parishes prayerfully review and choose, plan and act on mission activities that will help further the objectives of the Diocese. Deaneries and benefices are supported to this end by Deanery Mission Accompaniers.

We are looking to the way ahead with faith and hope as we seek to be a people united in Christ, celebrating our diversity and reaching out to local communities with the good news of the kingdom.

www.canterburydiocese.org